

Roller Blinds

Hunter Douglas EOS™ 500 roller blinds offer superior, high-quality operation, accompanied by an extensive range of fabrics to both control glare and prevent the build-up of heat.

Roller Blinds



Roller Blinds Effective and attractive

Project: Robeco - Location: Rotterdam, The Netherlands - Architect: Architecten Cie



Project: InterContinental Dubai Marina
Location: Dubai, United Arab Emirates -
Architect: Drawlink Group

The Hunter Douglas EOS™ 500 range of project roller blinds offers a wide choice of durable fabrics, which have been woven with great care, using the correct techniques and treated for the best result. The roller blinds are extremely versatile and combine many potential applications with a powerful, user-friendly operating system with which to control heat build-up and glare from sunlight.

QUALITY AND COMFORT

Roller blinds have a significant effect on the comfort in a sleek interior, whether it's a small office or a huge public space.

The Hunter Douglas project range:

- Is suitable for use in almost any building, be it a new-build or refurbishment project
- Consists of sleek, flame-retardant, recyclable fabrics which keep their shape
- Contains the highest-performing fabrics in thermal insulation, which can subsequently contribute to a higher score in Green Building certification
- Has a simple, maintenance-free operating system
- Is constructed from modular components for fast and simple installation

FUNCTIONALITY

The Hunter Douglas EOS™ 500 range of project roller blinds consists of:

- A transparent project range
- A black-out project range

Both fabric ranges make use of the same assembly and operating systems. The EOS™ 500 roller blind system's design depends on the full dimensions, while the technical features are the same in all versions.

EOS™ 500 Roller Blinds

EASY INSTALLATION

Assembly on the window frame, the wall or the ceiling - everything is possible with the Hunter Douglas EOS™ 500. The simple, patented assembly system offers ease of installation and operation as well as a long-lasting maintenance-free system. Patented features include:

- Modular installation of the chain operating system, which can be placed both to the right and the left
- A universal spring-loaded plug in the roller tube, which aids fast assembly
- Exact alignment of the bottom rail thanks to easily-connected multiple roller blinds
- A maximum of three systems can be connected to a single point of operation (both manual and motorized).

THE STRENGTHS OF EOS™ 500

The sleek design, smooth operating and wide range of applications make the EOS™ 500 an attractive product for any project, even those with large windows.

Hunter Douglas Roller Blinds give the feeling of personal involvement and allow a pleasant view. Moreover, the roller blinds also prevent heat from the sun.

If you would like to know what the most sustainable solution is for your project, you can be sure that Hunter Douglas has the knowledge and expertise to give you the right advice.

FACT AND FIGURES

The Hunter Douglas EOS™ 500 roller blinds:

- Tailor-made to clients' specifications
- Range of fabrics includes a large selection with a glare classification of 3 and 4
- Contribute to the reduction of indoor heat accumulation (in combination with a metallised reverse side)
- Not only protect against the sun, but also filter out UV light
- Come with a smooth operating system



STANDARD AND COUNTER-ROLLING

The Hunter Douglas blind can be unrolled from the system in two ways, namely:

- Standard rolling (back rolling)
- Counter rolling (front rolling)

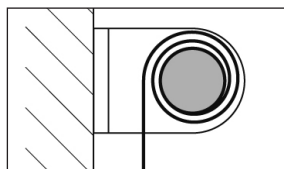

Standard rolling

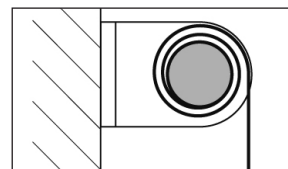

Counter rolling

OPERATING SYSTEM

Hunter Douglas EOS™ 500 roller blinds can be operated in a number of ways:

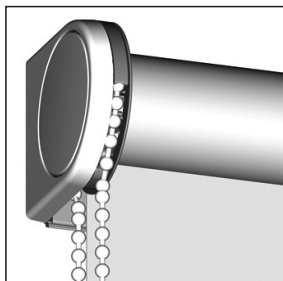

Chain operation

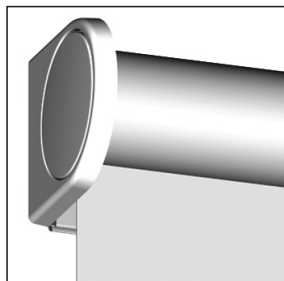

LiteRise™

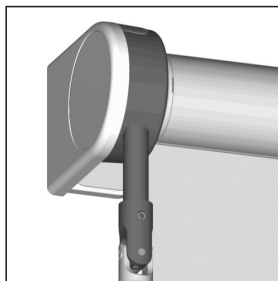

Crank rod

MOTORIZED

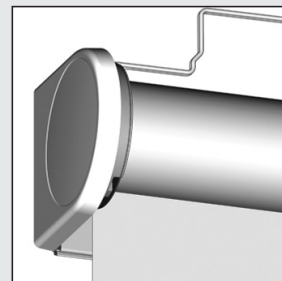

- Motorized 24V
- Motorized 230V

* LiteRise™ is an extremely user-friendly operating system with which to bring the bottom rail to the desired height.
Available in a limited range of sizes.

GUIDANCE SYSTEM

Various types of guidance systems have been developed for the EOS™ 500 roller blinds to suit a variety of areas of application and desired effects. Guidance systems are generally used in the case of high, narrow windows, extreme internal airflow, black-out or for a more stable construction

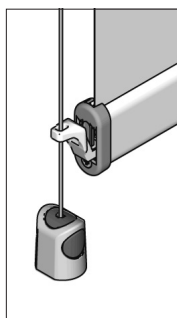

Daytime cable guidance

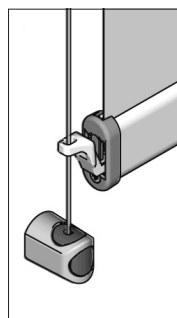

Standard side guidance

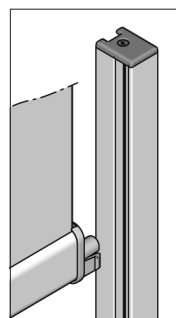

Daily cable guidance

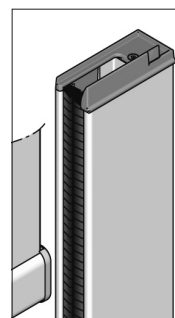

Black-out side guidance

BOTTOM RAIL

The bottom rail is available in three finishes.

S-SERIES

Standard: Oval bottom rail

Optional: Rectangular XL or Oval XL

M-SERIES

Standard: Rectangular XL

Optional: Oval XL or Oval bottom rail

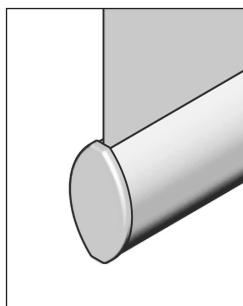

Oval bottom rail
(266 gr/m)

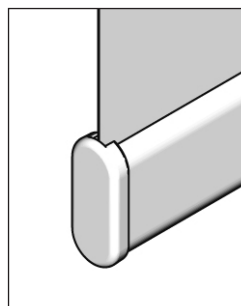

Rectangular XL
(390 gr/m)

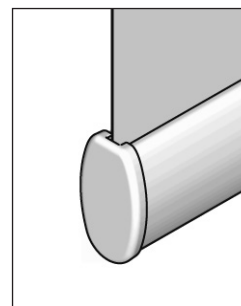

Oval XL bottom rail
(390 gr/m)

COUPLING

The EOS™ 500 roller blinds with chain operation, crank rod or motor can be coupled.

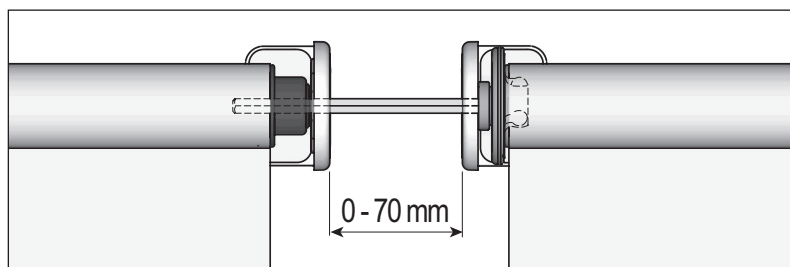

HANGING SYSTEMS

The Hunter Douglas EOS™ 500 roller blind range consists of three hanging systems: brackets, mounting profiles and cassettes. Please see below the various finishes with the accompanying dimensions for each system.

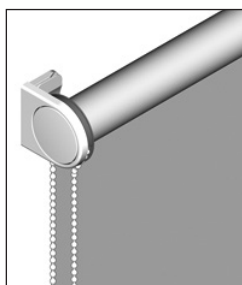

Brackets

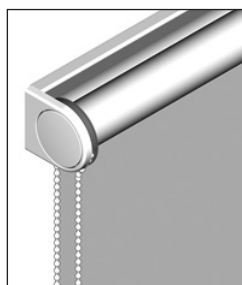

Mounting profile

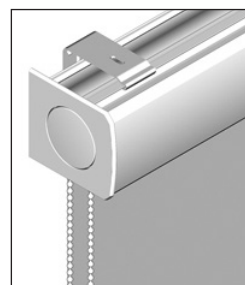

Cassette

DIMENSIONS

The construction and dimensions of the S Series (up to sizes of 2500 x 3000 mm*) are as follow:

Brackets (5-410)

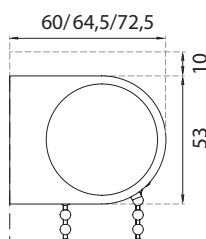
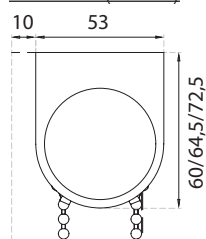

Mounting profile (5-420)

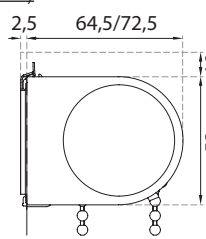
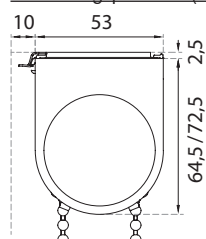

Cassette (5-470/490)

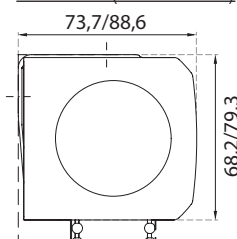

The construction and dimensions of the M Series (up to sizes of 3600 x 4000 mm*) are as follows:

Brackets (5-10)

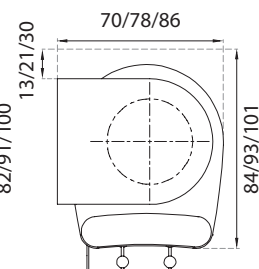
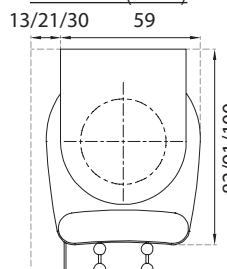

Mounting profile (5-20)

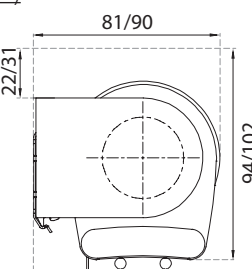
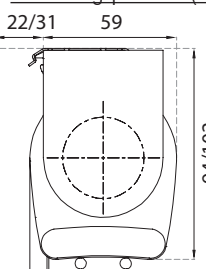

Cassette (5-50/60)

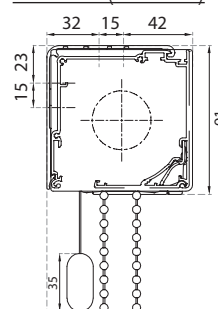

*Depending on the operating system and the type of fabric used.

Should larger sizes or special solutions (such as for a skylight) be desired, please get in touch with your nearest Hunter Douglas branch.

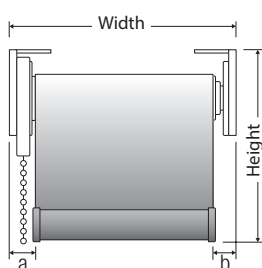

WIDTH OF S SERIES SYSTEM (Dimensions dependent on the type of roller blind system)

	Chain operation	LiteRise®	Motorized 24V	Motorized 230V	Crank rod
a	17 mm	13 mm	16/24/25 mm	-	-
b	10/15 mm*	10 mm	10/15 mm*	-	-

WIDTH OF M SERIES SYSTEM (Dimensions dependent on the type of roller blind system)

	Chain operation	LiteRise®	Motorized 24V	Motorized 230V	Crank rod
a	21 mm	-	16 mm	28 mm	30 mm
b	17/18/19/20 mm*	-	17/18/19/20 mm*	17/18/19/20 mm*	19/20 mm*

*Depending on the type of roller blind.

The cassette is available in a number of designs in the M Series, including:

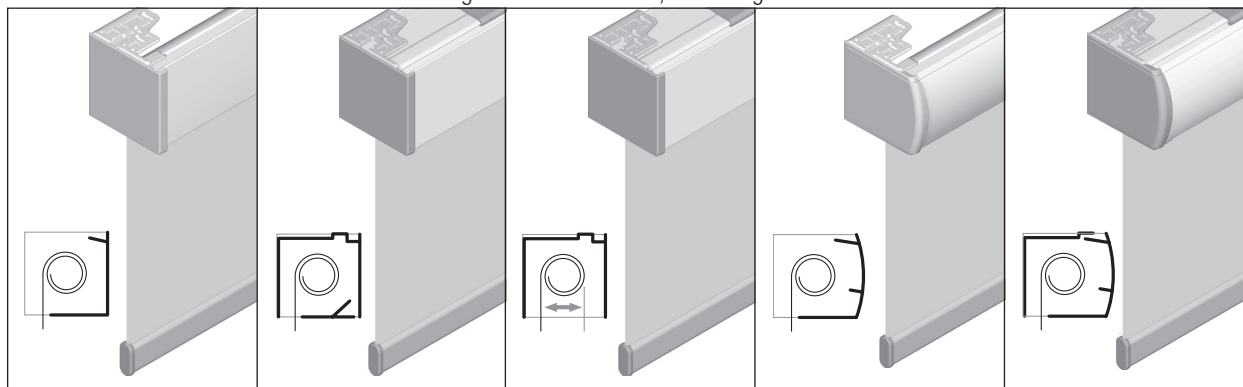

Straight valance
(5-30)

Square cassette
(5-70)

U cassette (5-90)

Design valance
(5-300)

Design cassette
(5-310)

Window Coverings
Ceilings
Sun Control
Façades



China
Hong Kong
India
Indonesia
Japan
Korea
Malaysia
Philippines
Singapore
Taiwan
Thailand
Vietnam

Australia
Europe
Latin America
North America

Hunter Douglas Asia Operations
Tel: +603 5191 2020

www.hunterdouglas.asia



Copyright by Hunter Douglas.
Technical data subject to change without notice.
201006-4-1.0

®Registered trademark of Hunter Douglas